

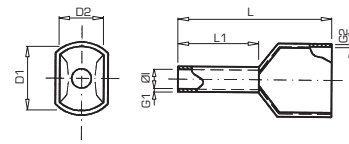

APF/D
Twin cord end terminal

APF/D cord end terminal manufactured from electrolytic copper capillary tube with a tinplated finish to improve electrical contact. The insulating part is made of polypropylene (PP). It is designed for electrical panel boards.



APF/D
Twin cord end terminal

APF/D cord end terminal manufactured from electrolytic copper capillary tube with a tinplated finish to improve electrical contact. The insulating part is made of polypropylene (PP). It is designed for electrical panel boards.

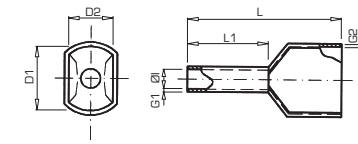

255 APF/D - 256 APF/D - 258 APF/D

Section (mm ²)	L1	Code	Ref.	Colour		Code	Ref.	Colour		Code	Ref.	Colour	DIN	Section (mm ²)	Dimensions (mm)						Kg x 1.000	Bag	Box	
				F	W			W	DIN						ØI	D2	D1	L	L1	G1				G2
0,50	8	255100	APF/D-0,50 D	WHITE	ORANGE	256100	APF/D-0,50 W	ORANGE	WHITE	255100	APF/D-0,50 D	WHITE		0,50	1,5	2,5	4,7	15,0	8,0	0,15	0,25	0,110	100	3500
0,75	8	258110	APF/D-0,75	BLUE	WHITE	256110	APF/D-0,75 W	WHITE	GREY	255110	APF/D-0,75 D	GREY		0,75	1,8	2,8	5,0	15,0	8,0	0,15	0,25	0,140	100	3500
1	8	255120	APF/D-1,00 D	RED	YELLOW	256120	APF/D-1,00 W	YELLOW	RED	255120	APF/D-1,00 D	RED		1	2,3	3,4	5,4	15,0	8,0	0,15	0,30	0,160	100	2500
1,5	8	255130	APF/D-1,50 D	BLACK	RED	256130	APF/D-1,50 W	RED	BLACK	255130	APF/D-1,50 D	BLACK		1,5	2,3	3,6	6,6	16,0	8,0	0,15	0,30	0,200	100	2000
2,5	10	258140	APF/D-2,50	GREY	BLUE	255140	APF/D-2,50 D	BLUE	BLUE	255140	APF/D-2,50 D	BLUE		2,5	2,9	4,2	7,8	18,5	10,0	0,20	0,30	0,300	100	1000
4	12	258150	APF/D-4,00	ORANGE	GREY	255150	APF/D-4,00 D	GREY	GREY	255150	APF/D-4,00 D	GREY		4	3,8	4,9	8,8	23,0	12,0	0,20	0,30	0,460	100	800
6	14	258160	APF/D-6,00	GREEN	BLACK	256160	APF/D-6,00 W	BLACK	YELLOW	255160	APF/D-6,00 D	YELLOW		6	4,9	6,9	10,0	26,0	14,0	0,20	0,40	0,640	100	500
10	14	258170	APF/D-10,00	BROWN	IVORY	256170	APF/D-10,00 W	IVORY	RED	255170	APF/D-10,00 D	RED		10	6,5	7,2	13,0	26,0	14,0	0,20	0,40	0,990	100	400
16	14	258180	APF/D-16,00	IVORY	GREEN	256180	APF/D-16,00 W	GREEN	BLUE	255180	APF/D-16,00 D	BLUE		16	8,3	9,6	18,4	30,0	14,0	0,30	0,40	1,450	100	200