

sofamel

Product Technical Specifications

Mod. M

Copper butt-connector



Functionality

Copper butt-connectors for connections of electrical circuits. They are used in a wide range of sections, both for flexible and rigid copper cables in distribution networks.

These terminals must be crimped by **hexagonal compression**.

Product Features

Manufactured from electrolytic copper with a tinplated finish to improve electrical contact.

Incorporates a central top which facilitates the correct cable positioning.

The Sofamel butt-connectors are marked with the Sofamel logo and the section.

The sections of this product can range from **1.5 to 630 mm²**.

Raw Material Features

99.9% electrolytic copper.

Specific gravity: **8.95 gr/cm³**.

Conductivity at 20°C: **58.14 Siemens x m/mm²**.

Resistivity at 20°C: **0.0172 Ohms x mm²/m**.

Surface treatment: **tin bath 5µ thick**.



Mod. M

Copper butt-connector

Dimensions

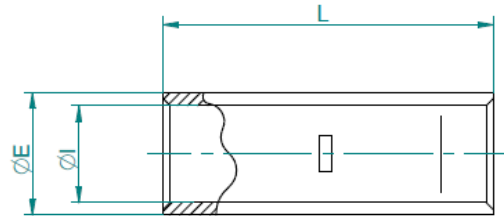

COD.	SEC.	REF.	ØE	ØI	L
15100	1,5	M-1,5	3,3	1,8	15,0
15110	2,5	M-2,5	4,3	2,7	15,0
15120	4	M-4	5,0	3,3	22,0
15130	6	M-6	5,5	3,8	22,0
15140	10	M-10	6,8	4,7	25,0
15150	16	M-16	7,8	5,6	27,0
15160	25	M-25	9,4	7,1	29,0
15170	35	M-35	11,3	8,7	33,0
15190	50	M-50	12,6	9,8	35,0
15200	70	M-70	14,7	11,5	39,0
15210	95	M-95	16,9	13,5	43,0
15220	120	M-120	19,9	15,6	47,0
15230	150	M-150	20,9	16,5	58,0
15240	185	M-185	23,7	18,9	64,0
15250	240	M-240	26,2	21,2	75,0
15260	300	M-300	28,6	23,4	90,0
15270	400	M-400	32,8	26,8	90,0
15280	500	M-500	38,4	29,8	98,0
15290	630	M-630	44,7	34,5	105,0

Certified

According to the Standards:

IEC 61238-1.

Comply with Directive **2002/95 / EC** of the European Union (**RoHS**).